



CIV Forged Gate 800

Standards

Construction : API602, BS 5352

Flanged ASME CLASSES 150,300,600,1500

Socket Weld : Asme B16.11

Threaded Asme B1.20.1

Butt Weld : Asme B16.25

Test : API 598-BS 6755 (Pt.1)

ASME CLASS 800 : 1975 psi 100 °f

ASME CLASS 1500 : 3705 psi 100°F

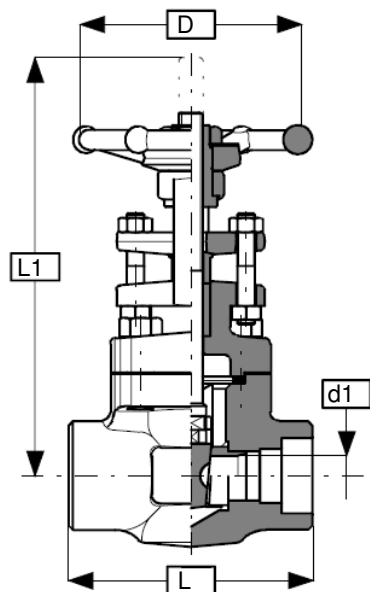

DN	d1	L	L1	D
1/2"	10	80	145	90
3/4"	14	90	156	90
1"	18	110	186	100
1.1/4"	24	127	216	120
1.1/2"	31	127	255	140
2"	9,1	130	273	140



CIV Forged Gate
1500

Standards

Construction : API602, BS 5352

Flanged ASME CLASSES 150,300,600,1500

Socket Weld : Asme B16.11

Threaded Asme B1.20.1

Butt Weld : Asme B16.25

Test : API 598-BS 6755 (Pt.1)

ASME CLASS 800 : 1975 psi 100 °f

ASME CLASS 1500 : 3705 psi 100°F

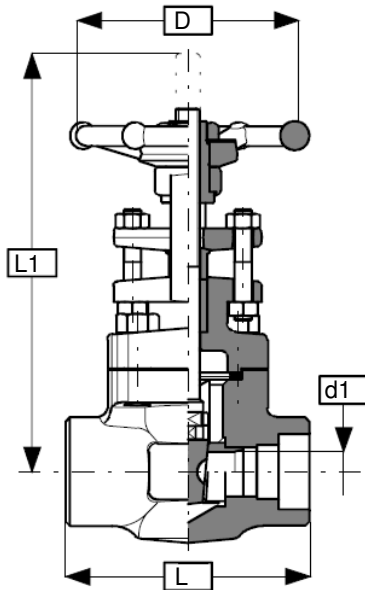

DN	d1	L	L1	D
1/2"	13	102	197	90
3/4"	13	127	200	90
1"	18	152	244	125
1.1/4"	32	178	270	150
1.1/2"	32	178	270	150
2"	38	229	312	250

CIV Forged Globe 800



Standards

Construction : API602, BS 5352

Flanged ASME CLASSES 150,300,600,1500

Socket Weld : Asme B16.11

Threaded Asme B1.20.1

Butt Weld : Asme B16.25

Test : API 598-BS 6755 (Pt.1)

ASME CLASS 800 : 1975 psi 100 °f

ASME CLASS 1500 : 3705 psi 100°F

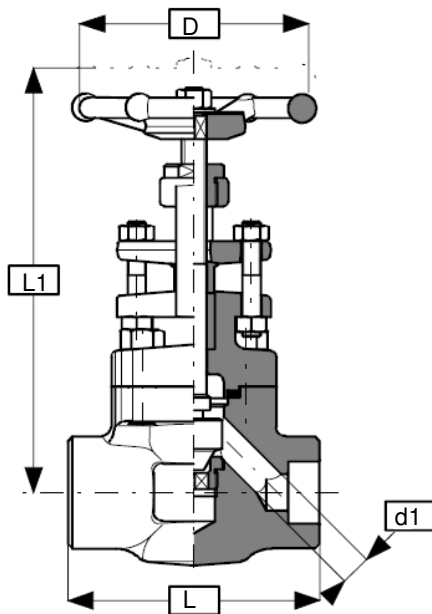

DN	d1	L	L1	D
1/2"	8	73	122	64
3/4"	13	83	180	105
1"	19	89	185	105
1.1/4"	32	127	221	150
1.1/2"	32	127	221	150
2"	38	203	285	200

CIV Forged Globe 1500



Standards

Construction : API602, BS 5352

Flanged ASME CLASSES 150,300,600,1500

Socket Weld : Asme B16.11

Threaded Asme B1.20.1

Butt Weld : Asme B16.25

Test : API 598-BS 6755 (Pt.1)

ASME CLASS 800 : 1975 psi 100 °f

ASME CLASS 1500 : 3705 psi 100°F

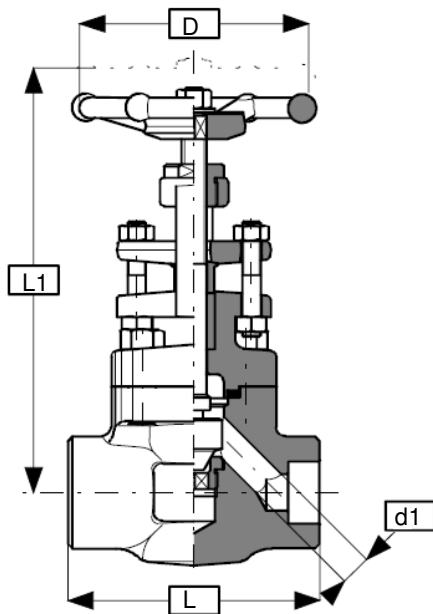

DN	d1	L	L1	D
1/2"	13	102	206	150
3/4"	13	127	213	150
1"	19	152	254	200
1.1/4"	32	178	279	200
1.1/2"	32	178	279	200
2"	38	229	312	300

CIV Forged Check 800

Standards



Piston , Ball or Swing type ASME CLASSES 800 , 1500

Socket Weld : Asme B16.11

Threaded Asme B1.20.1

Butt Weld : Asme B16.25

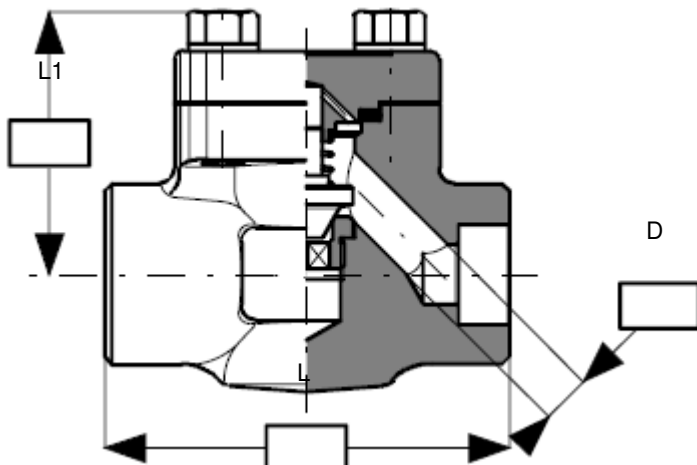

DN	D	L	L1
1/2"	12.7	89	64
3/4"	12.7	89	64
1"	19.1	127	89
1.1/4"	31.8	133	86
1.1/2"	31.8	133	86
2"	38.1	152	109

CIV Forged Check
1500

Standards



Piston , Ball or Swing type ASME CLASSES 800 , 1500

Socket Weld : Asme B16.11

Threaded Asme B1.20.1

Butt Weld : Asme B16.25

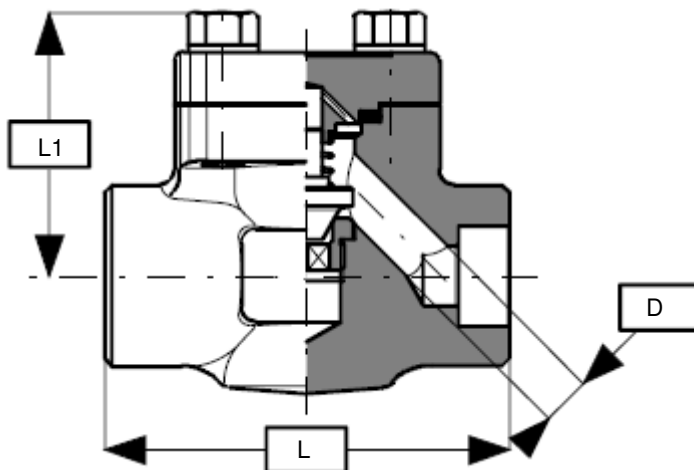

DN	D	L	L1
1/2"	12.7	152	94
3/4"	12.7	152	94
1"	19.1	152	94
1.1/4"	31.8	178	94
1.1/2"	31.8	178	107
2"	38.1	229	132