

CIV Strainer 16



Construction :

Ductil cast iron body cover and cover . Stainless steel screen.

Connection flanges dressed and drilled according to EN 11092-2 PN 16 with raised face.

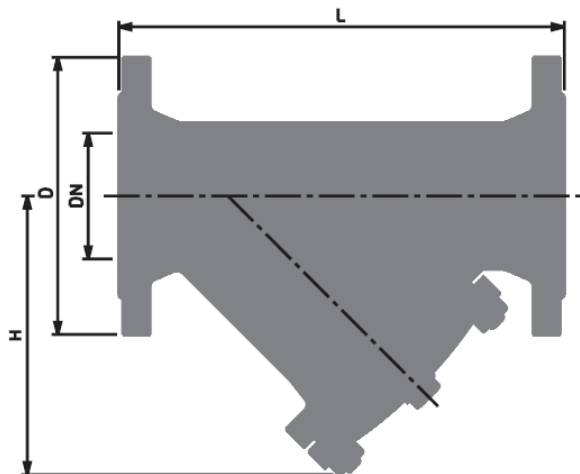

DN	D	L	H
40	150	200	126
50	165	230	134
65	185	290	182
80	200	310	208
100	220	350	240
125	250	400	280
150	285	480	325
200	340	600	400
250	405	730	485

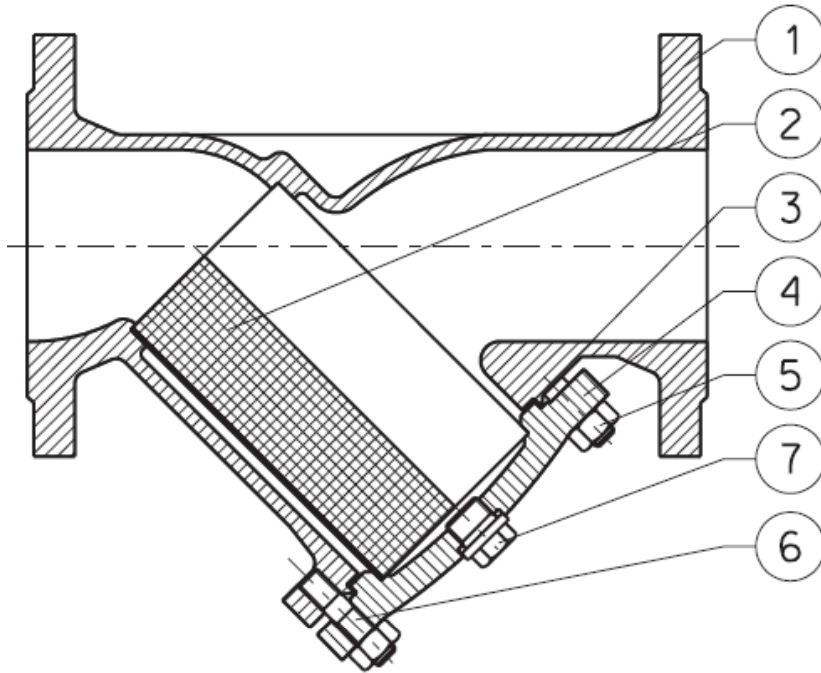

CIV Strainer 16

List Materials

	Part Name	Material
1	Body	Ductil Iron; Cast Iron ; Stainlees steel ; Special alloys*
2	Strainer	SS304 ; lcr18Ni9TI
3	Cover	Ductil Iron; Cast Iron ; Stainlees steel ; Special alloys*
4	Washer	PTFE+graphite
5	Bolt	steel
6	Bolt	steel
7	-	-

CIV Strainer 40



Construction :

Carbon steel body and bonnet. Stainless steel screen. Asbestos free gasket. Connection flanges dressed and drilled according to EN 1092-1

PN 40 with raised face.

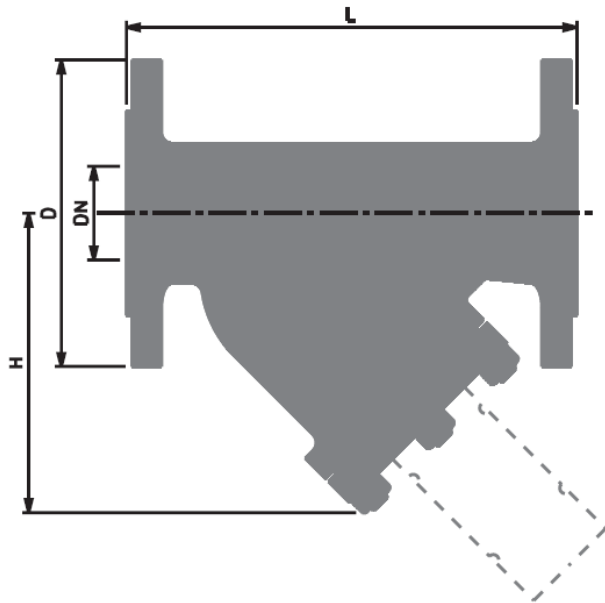

DN	D	L	H
15	95	130	70
20	105	150	75
25	115	160	80
32	140	180	90
40	150	200	100
50	165	130	115
65	185	190	130
80	200	310	145
100	235	350	170
125	270	400	220
150	300	480	290
200	375	600	370
250	450	730	420
300	515	850	530

CIV Strainer 40

List Materials

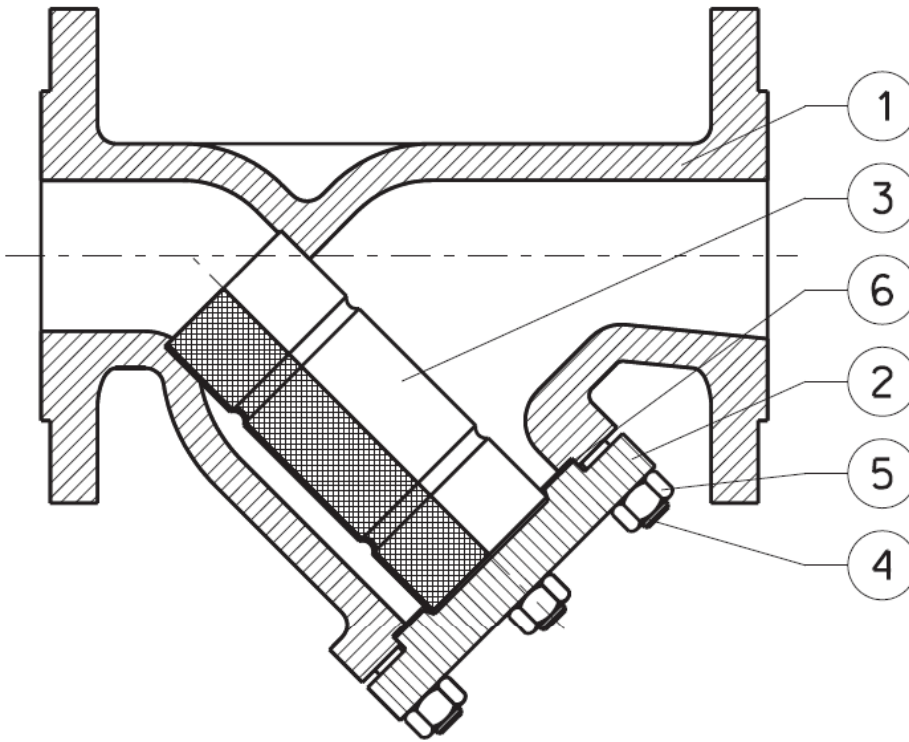

	Part Name	Material
1	Body	Ductil Iron ; Stainlees steel ; Special alloys*
2	cover	Ductil Iron; Stainlees steel ; Special alloys*
3	Screen	AISI 304 ; ST.STEEL
4	Stud	Carbon steel
5	Nut	Carbon steel
6	Gasket	Asbestos free
7	-	-

CIV Strainer 16 Sediment

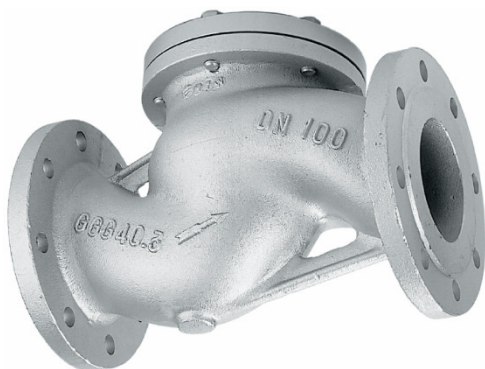

Construction :

Nodular cast iron body. Carbon steel cover.
Stainless steel screen . Connection flanged
dressed and drilled according to EN 1092-2 PN 16
standards with raised face.

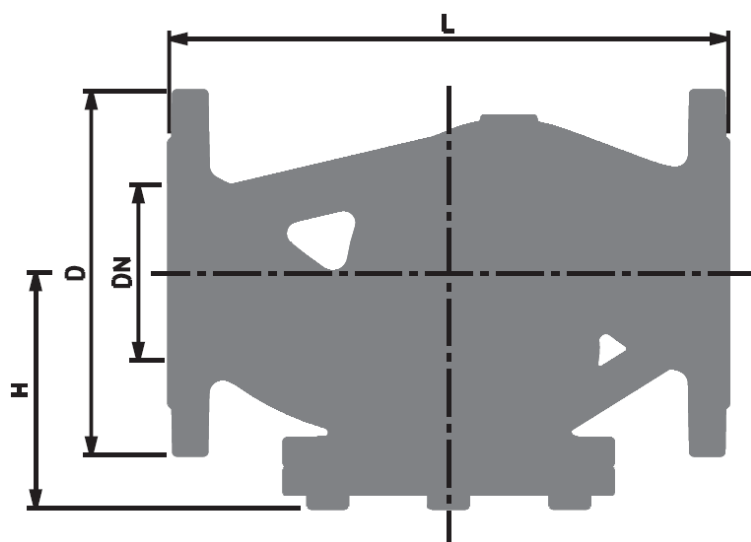

DN	D	L	H
15	95	130	73
20	105	150	73
25	115	160	78
32	140	180	90
40	150	200	105
50	165	130	113
65	185	190	143
80	200	310	150
100	220	350	165
125	250	400	185
150	285	480	205
200	340	600	245
250	405	730	313
300	460	850	355

Data given this catalogue may be changed without notice

On request CIV supply valves up to 72" in SS, CS , CI , DI , Monel , Inconel.

CIV Strainer 16 Sediment

Material List

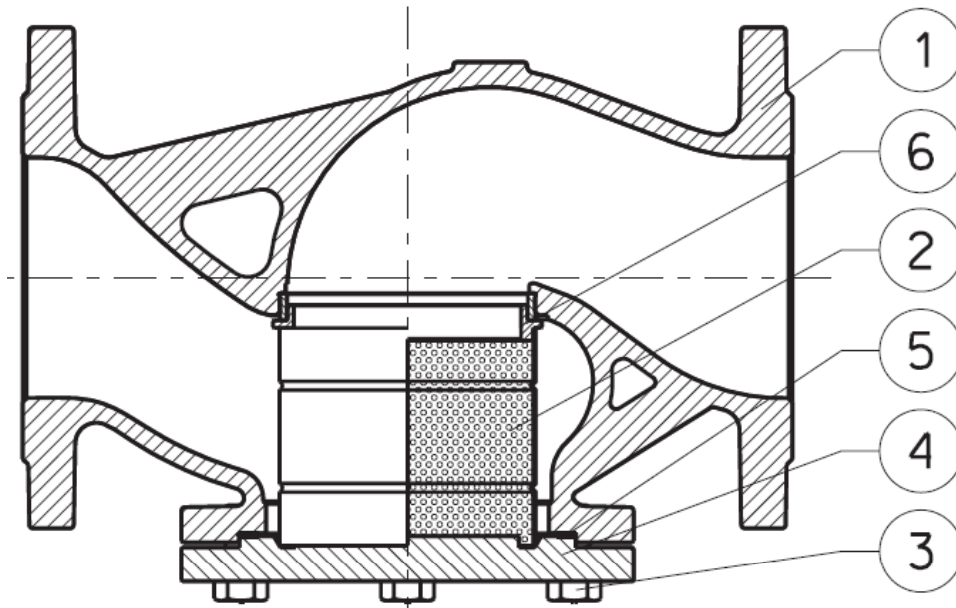

	Part Name	Material
1	Body	Ductil Iron; Cast Iron ; Stainlees steel ; Special alloys*
2	Screen	Aisi 304 St.Steel
3	Screw	8.8 Steel
4	cover	Ductil Iron; Cast Iron ; Stainlees steel ; Special alloys*
5	Gasket	Graphite + Stainless steel
6	Central ring	Steel
7	-	-

Data given this catalogue may be changed without notice

On request CIV supply valves up to 72" in SS, CS , CI , DI , Monel , Inconel.

CIV Strainer 25 Sediment



Construction :

Nodular cast iron body. Carbon steel cover.
Stainless steel screen . Connection flanged
dressed and drilled according to EN 1092-2 PN 25
standards with raised face.

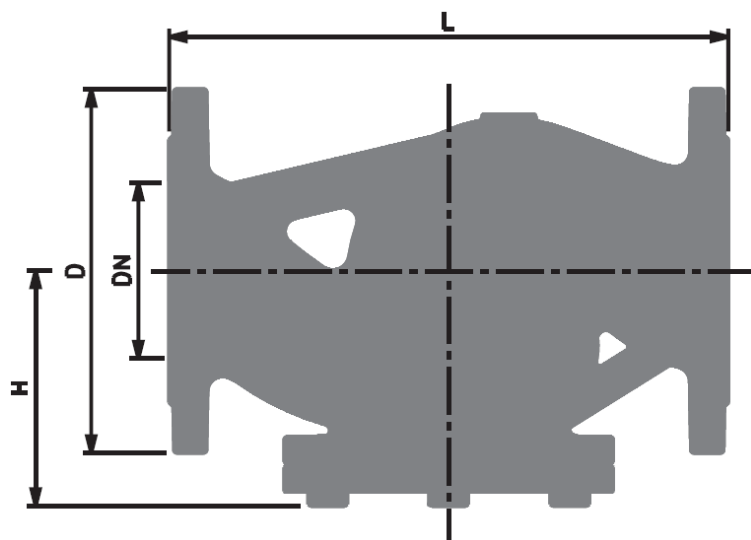

DN	D	L	H
15	95	130	73
20	105	150	73
25	115	160	78
32	140	180	90
40	150	200	105
50	165	130	113
65	185	190	143
80	200	310	150
100	235	350	165
125	270	400	185
150	300	480	205

Data given this catalogue may be changed without notice

On request CIV supply valves up to 72" in SS, CS , CI , DI , Monel , Inconel.

CIV Strainer 25 Sediment

Material List

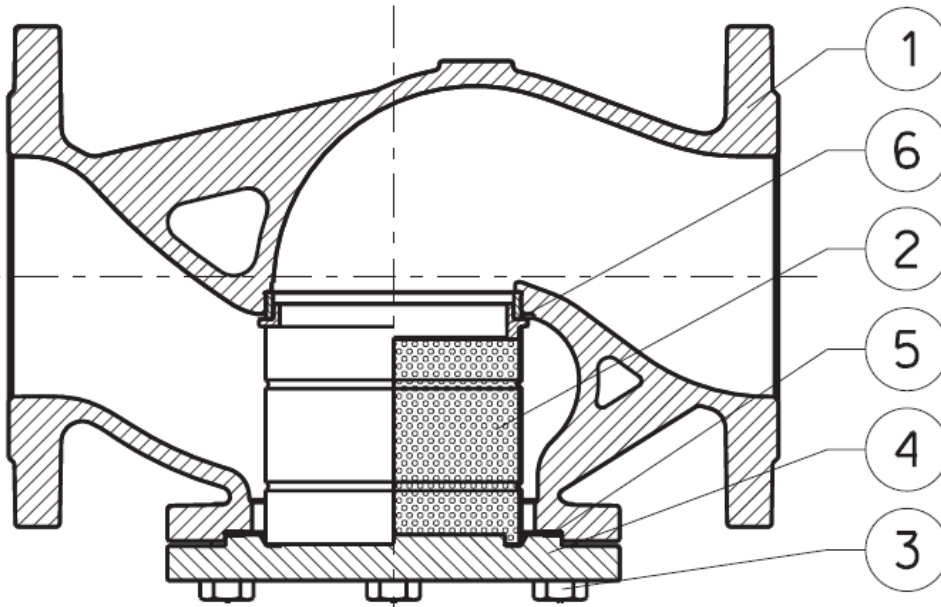

	Part Name	Material
1	Body	Ductil Iron; Stainlees steel ; Special alloys*
2	Screen	Aisi 304 St.Steel
3	Screw	8.8 Steel
4	cover	Ductil Iron; Stainlees steel ; Special alloys*
5	Gasket	Graphite + Stainless steel
6	Central ring	Steel
7	-	-

Data given this catalogue may be changed without notice

On request CIV supply valves up to 72" in SS, CS , CI , DI , Monel , Inconel.

CIV Strainer 40 Sediment



Construction :

Nodular cast iron body. Carbon steel cover.
Stainless steel screen . Connection flanged
dressed and drilled according to EN 1092-2 PN 40
standards with raised face.

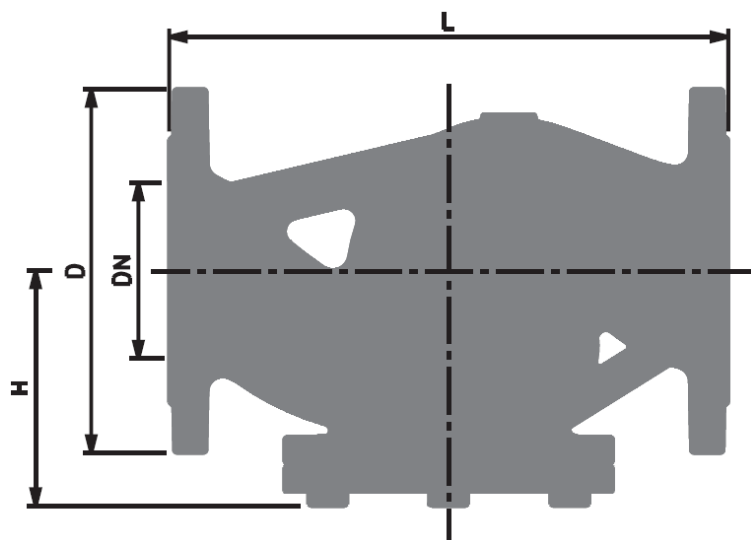

DN	D	L	H
15	95	130	73
20	105	150	73
25	115	160	78
32	140	180	90
40	150	200	105
50	165	130	113
65	185	190	143
80	200	310	150
100	235	350	165
125	270	400	185
150	300	480	205

Data given this catalogue may be changed without notice

On request CIV supply valves up to 72" in SS, CS , CI , DI , Monel , Inconel.

CIV Strainer 40

Sediment

Material List

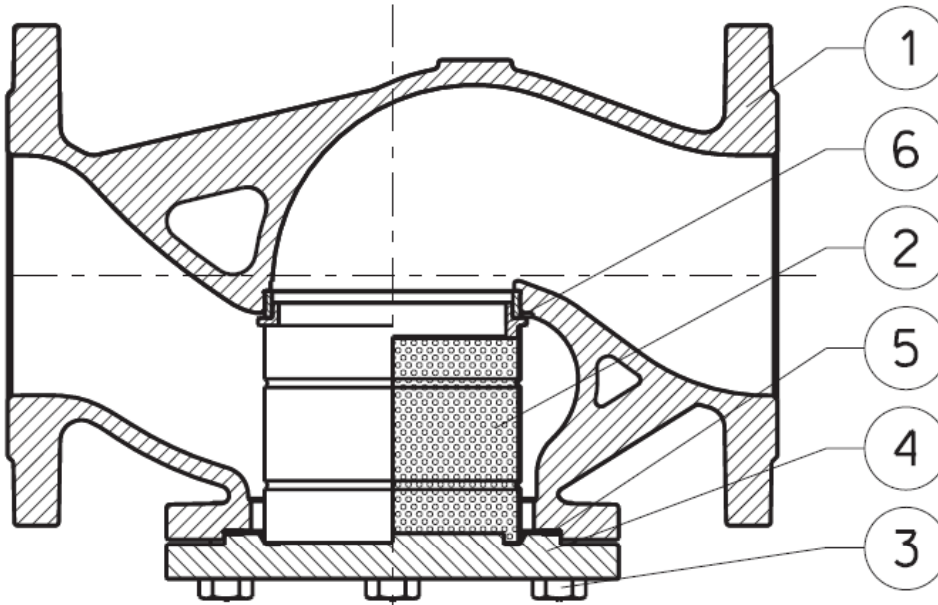

	Part Name	Material
1	Body	Ductil Iron; Stainlees steel ; Special alloys*
2	Screen	Aisi 304 St.Steel
3	Screw	8.8 Steel
4	cover	Ductil Iron; Stainlees steel ; Special alloys*
5	Gasket	Graphite + Stainless steel
6	Central ring	Steel
7	-	-

Data given this catalogue may be changed without notice

On request CIV supply valves up to 72" in SS, CS , CI , DI , Monel , Inconel.



FEATURES:

The thread ends conform to ASME B1.20.1(NPT)DIN 2999 & BS 21 ISO 228/1 & ISO 7/1
 Investment casting
 Max working temperature 445 F
 600 W.O.G.
 800 W.O.G. (Option)

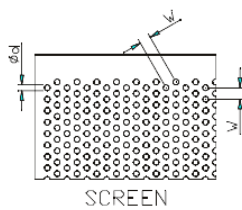
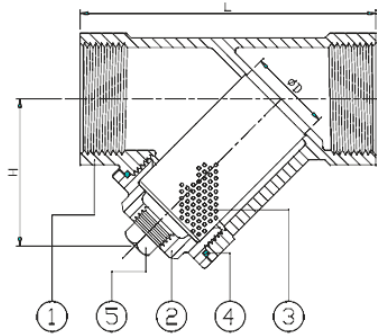

Applicable Standard			
Test and Inspection		API 598	
ITEM	PARTS	MATERIAL	
1	BODY	ASTM A351-CF8M 1.4408	ASTM A276-316
2	CAP		
3	SCREEN	AISI 316	
4	GASKET	PTFE	
5	DRAIN PLUG	ASTM A351-CF8M 1.4408	